

OMBRA
TOSCANA

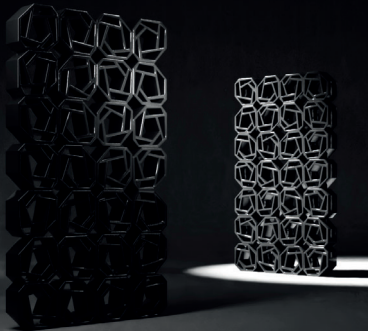

The
Stone
Project





From the landscape of Tuscany

In the outskirts of the worldwide renowned Val D'Orcia, Silvano and Franca (CEI and PO) started working on terracotta over 40 years ago.

Since then, they have never lost the love for this unique and eclectic material.

From the risk of interrupting the production after the closure of the local furnace and subsequently moving the whole family somewhere else, they saw the opportunity to follow their dreams and create UNIQUENESS.

Thanks to ancient knowledge and deep passion for the material, the typical entrepreneurship of the Tuscan people and their creative vision they made all the right investments in spaces, people and equipment to take CEIPO to the most advanced design level.



In times where what's new turns immediately old, the old shows its contemporaneity: SUNSCREENS have been largely adopted in the past to partitionate spaces, guarantee privacy and provide proper airflow in the buildings. Several examples of this elements can be found all over the region in Medieval churches, barns, castels, monasteries etc...





The newest technologies available today, the most up to date equipment, the expertise our craftsmen gained across decades, allows CEIPO to maximize all the qualities of its products.

The ductility of the raw materials and the refined design inspired by the interplay between light and shadow, make this a perfect architectural element in modern design, from interiors to landscaping.

This is why CEIPO products have been used in many type of projects across the world, from desert areas to freezing regions, from government buildings to private residences, both using the standard programs or challenging the Company to create custom shapes, like in the new Nike Store in NYC (see the next pages) or in the G.E.L (Green Energy Lab) in China, the first GOLD LEED Building in the PRC. .

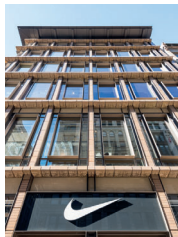

CEIPO moldings on the facade of new Nike
Store in NYC

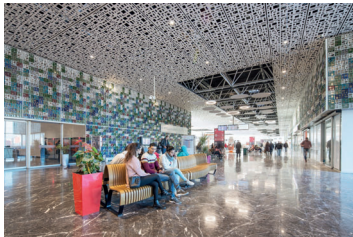

CEIPO moldings on the facade of new Nike Store in NYC

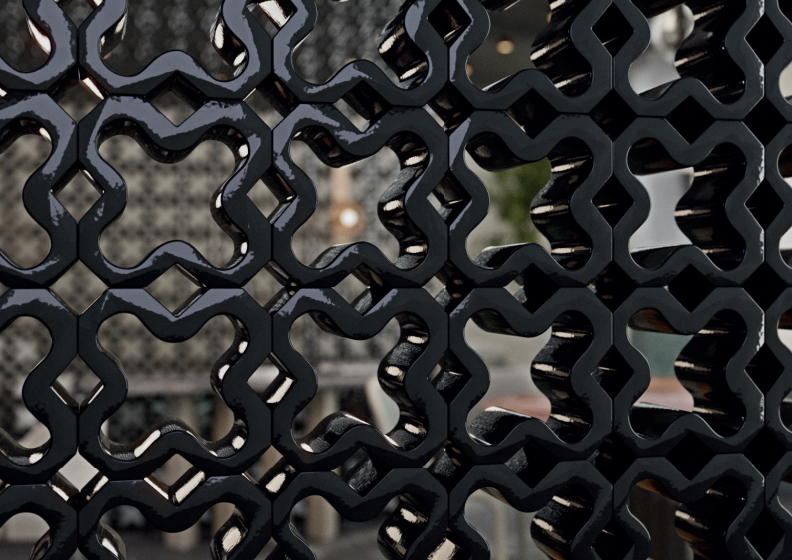

Shadows on the menù

Ombra 1
Ombra 2
Ombra 3
Ombra 4
Ombra 5
Ombra 6
Ombra 7
Ombra 9

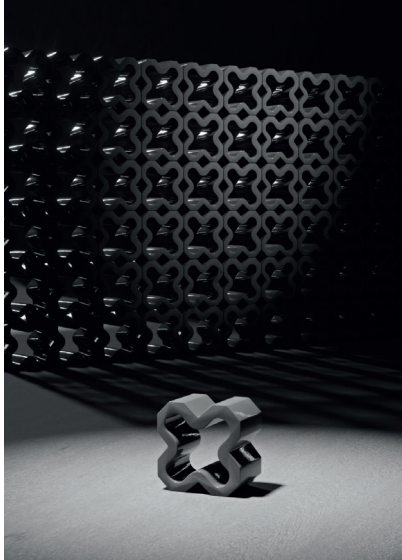

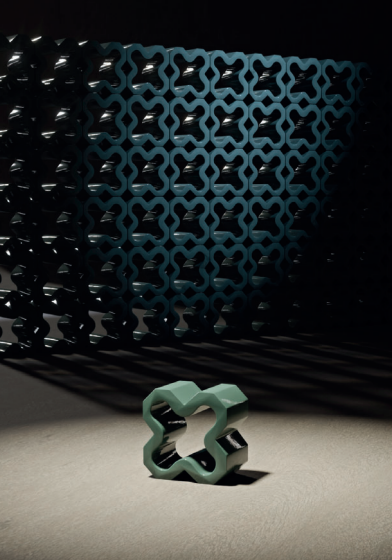

Coloured shadows



Ombra 01



Gres dimensions

14.7 x 29.6 x 6 \ 14.7 x 29.6 x 10 cm

Finishes

glazed and unglazed

Weight each

kg 2.2 or 3.6

Pieces per box

5 or 3

Water absorption

< 0.1%

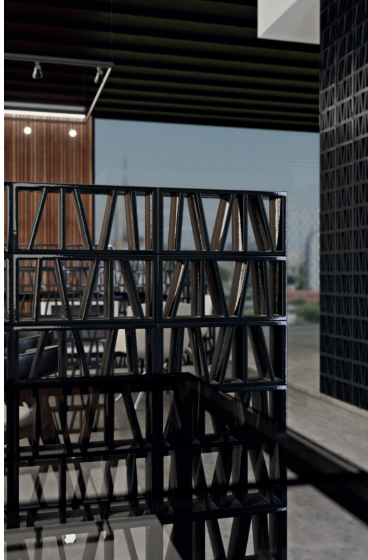



Ombra 02



Gres dimensions

28 x 13.5 x 6 \ 28 x 13.5 x 10 cm

Finishes

glazed and unglazed

Weight each

kg 1.416 \ 2.36

Pieces per box

5 or 3

Water absorption

< 0.1%

Ombra 03



Gres dimensions

26.5 x 12.3x6 \ 26.5 x 12.3 x 10 cm

Finishes

glazed and unglazed

Weight each

kg 1.35 \ 2.20

Pieces per box

5 or 3

Water absorption

< 0.1%

Ombra 04

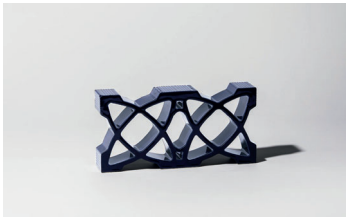

Gres dimensions

14.3 x 29.4 x 6 \ 14.3 x 29.4 x 10 cm

Finishes

glazed and unglazed

Weight each

kg 2.05 \ 3.39

Pieces per box

5 or 3

Water absorption

< 0.1%

Ombra 05



Gres dimensions

17.6 x 17.3 x 6 \ 17.6 x 17.3 x 10

Finishes

glazed and unglazed

Weight each

kg 1.16 \ 1.93

Pieces per box

5 or 3

Water absorption

< 0.1%

Ombra 06



Gres dimensions

18,5 x 18,5 x 6 \ 18,5 x 18,5 x 10 cm

Finishes

glazed and unglazed

Weight each

kg 1.80 \ 2.75

Pieces per box

5 or 3

Water absorption

< 0.1%

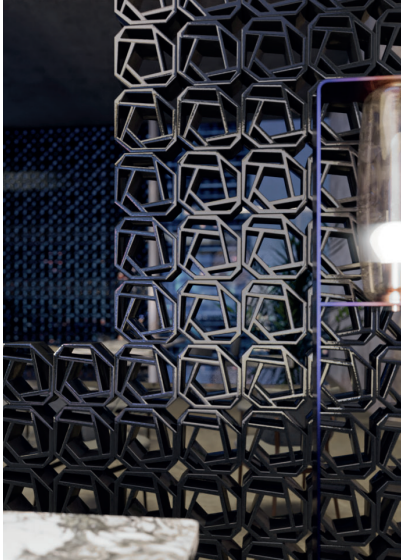



Ombra 07



Gres dimensions

20,5 x 20.5 x 6 \ 20,5 x 20.5 x10 cm

Finishes

glazed and unglazed

Weight each

kg 2.44 \ 4

Pieces per box

5 or 3

Water absorption

< 0.1%





Ombra 08



Gres dimensions

20,6 x 20,6 x 6 \ 20,6 x 20,6 x 10 cm

Finishes

glazed and unglazed

Weight each

kg 1.97 \ 3.29

Pieces per box

5 or 3

Water absorption

< 0.1%

Ombra 09



Gres dimensions

15,8 x 15.6 x 6 \ 15,8 x 15.6 x 10
cm

Finishes

glazed and unglazed

Weight each

kg 1.5 \ 2.50

Pieces per box

5 or 3

Water absorption

< 0.1%





10 New Maple Ave.
Suite 307
Pine Brook, NJ 07058

www.thestoneproject.net